

GRF-M-2 / GRF-M-4

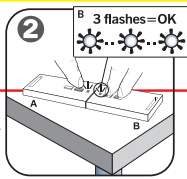
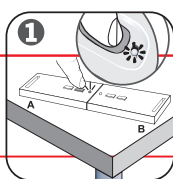

PROGRAMACIÓN SIDE-PROG / SIDE-PROG PROGRAMMING

A=emisor dado de alta en una instalación / émetteur déjà mémorisé dans une installation / transmitter registered in an installation / Installation angemeldeten Sender / trasmettitore memorizzato in una installazione / reeds geprogrammeerde zender / emissor dado de alta numa instalação / μεταδότη που έχει εγγραφεί σε μια εγκατάσταση

B=nuevo emisor / nouvel émetteur / new transmitter / neuer Sender / nuovo trasmettitore / nieuwe zender / novo emissor / νέος μεταδότης

COD. 1246028 /1.0
- D00052

DATOS TÉCNICOS TECHNICAL DATA

Freq. 868,35MHz
3Vdc CR2032 / 12m A
Radiated power <25m W
Temp. -20°C - +55°C

BATTERY REPLACEMENT

